



Tri-Folding Wireless Keyboard

IC-BK03

User Manual

Package Contents

- 1 x Tri-folding Wireless Keyboard
- 1 x USB-C Charging Cable
- 1 x Carry Bag
- 1 x Stand Holder for Smartphone/Tablet
- 6 x Silicone Pads for Balance
- 1 x User Manual

Specifications

Bluetooth Specification	Bluetooth 5.1
Unfold Dimensions	251.7*89.6*6.6mm/10.3*3.5*0.52in
Fold Dimensions	146.8*92.6*16mm
Operating Range	<10 meters
Stand-by Time	60 days
Charge Time	<2 hours
Uninterrupted Work Time	<80 hours
Lithium Battery Capacity	210 mAh
Lithium Battery Life	3 years
Key Life	3 million clicks
Front Side of Keyboard	ABS
Back Side of Keyboard	Stainless alloy

*Frequency band: 2402 MHz ~ 2480 MHz
 *Maximum transmission power: 0 dBm

Guide to use Silicon Pads

When you type on the table, if you feel unbalanced, please attach 4 silicon pads on the back of the keyboard corner.

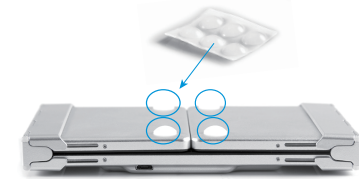

-1-

Product Descriptions

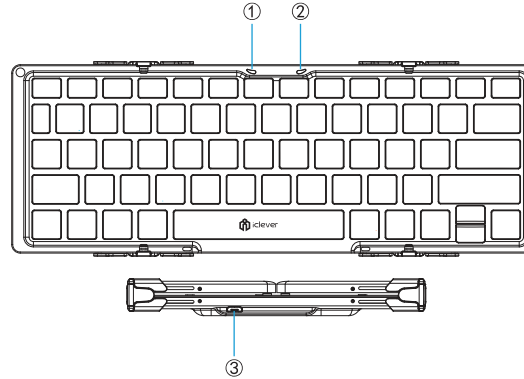

- Power/Charging/Low Battery/ Bluetooth Pairing Indicator**
Power indicator: when unfold the keyboard, the indicator will turn green for 3 seconds then to be off.
Charging indicator: stay in red while charging.
Low battery indicator: when battery is low, the indicator will keep flashing.
Bluetooth pairing indicator: press "fn" + "Z" to enter Bluetooth pairing mode.
- Indicator**
Caps lock indicator: press key of "caps lock" to switch between uppercase and lowercase. When the status is uppercase, the indicator will be on.
***for Android users, the indicator may not be on.**
- Charging Port**

-2-

Pairing Instructions

A.How to pair with 3 devices?

Pair with the 1st device

- Step 1: unfold the keyboard to power on.
- Step 2: press key of "fn" + "Q" simultaneously to choose Bluetooth Channel 1.
- Step 3: press key of "fn" + "Z" simultaneously to enter Bluetooth pairing mode, and the indicator will keep flashing blue.
- Step 4: on your device 1, find the Bluetooth name of "iClever IC-BK03 Keyboard" and click to connect it. The indicator will be off after fully paired.

Pair with the 2nd device

- Step 1: unfold the keyboard to power on.
- Step 2: press key of "fn" + "W" simultaneously to choose Bluetooth Channel 2.
- Step 3: press key of "fn" + "Z" simultaneously to enter Bluetooth pairing mode, and the indicator will keep flashing blue.
- Step 4: on your device 2, find the Bluetooth name of "iClever IC-BK03 Keyboard" and click to connect it. The indicator will be off after fully paired.

Pair with the 3rd device

- Step 1: unfold the keyboard to power on.
- Step 2: press key of "fn" + "E" simultaneously to choose Bluetooth Channel 3.
- Step 3: press key of "fn" + "Z" simultaneously to enter Bluetooth pairing mode, and the indicator will keep flashing blue.
- Step 4: on your device 3, find the Bluetooth name of "iClever IC-BK03 Keyboard" and click to connect it. The indicator will be off after fully paired.

Please note: when you unfold the keyboard, it will connect with last device automatically.

-3-

If fail to connect, please follow as below:

- On your device, delete/remove previous connections records with "iClever IC-BK03 Keyboard"
- On your device, turn off the Bluetooth function and turn on it again.
- Follow above pairing instruction to re-pairing it gain.

B.How to switch among connected devices?

Press key of "fn" + Q/W/E to switch among connected devices. ***please do not press "fn" + "Z" when switch among connected devices.**

C.How to re-pair a channel that has already been connected?

If you already pressing fn + Q/W/E to choose channel 1/2/3 with device 1/2/3, and you want to re-pair one of channel, please follow as below:

- Step 1: ensure which channel you expect to re-pair.
 For example, you already connect channel 1 with device 1, and expect to re-pair channel 1 with device 2.
- Step 2: press key of "fn" + "Q" simultaneously to choose Bluetooth Channel 1.
- Step 3: press key of "fn" + "Z" simultaneously to enter Bluetooth pairing mode, and the indicator will keep flashing blue.
- Step 4: on your device 2, find the Bluetooth name of "iClever IC-BK03 Keyboard" and click to connect it. The indicator will be off after fully paired.

Keyboard Language Switching

iOS 9 or above: ctrl + space

Mac OS: ctrl + space

Windows 7: ctrl + shift or alt + shift

Windows 10: win+ space

***For Android device, the shortcuts for language switching is different. Please try to switch language by pressing ctrl+space, shift + space, win + space or others.**

-4-

Function Keys

The table below describes special key combinations for different operating systems.

Function Keys	iOS	Android	Windows	Mac OS
	Switch function: Press fn + this key to switch to Bluetooth channel 1.			
	Switch function: press fn + this key to switch to Bluetooth channel 2.			
	Switch function: press fn + this key to switch to Bluetooth channel 3.			
	Bluetooth pairing function: press fn + this key to enter pairing mode, and the indicator will keep flashing.			
	It is combination used with blue icon key to perform related functions.			
	Press fn + this key to perform the function of virtual keyboard display. * this function work for iOS only.			
	It work as "win" when your system is windows. It work as "option" when system is iOS or Mac OS.			
	It work as "alt" when your system is windows or android. It work as "command" when system is iOS or Mac OS.			
	It work as "ctrl" when your system is windows or android. It work as "option" when system is iOS or Mac OS.			
	Press fn + to perform the function of page up.			
	Press fn + to perform the function of page down.			
	Press fn + to perform the function of home.			
	Press fn + to perform the function of end.			
	Hint function: press fn + this key to perform the function of insert. * this function work for windows only.			

-5-

Function Keys	iOS	Android	Windows	Mac OS	Windows or Mac OS
Way to use	Press fn +	Press fn +	Press fn +	Press fn +	Press Fn + shift +
	N/A	Esc or N/A	Esc	Esc	N/A
	Home	Home or N/A	Web browser	Mission Control	F1
	Brightness -	Brightness -	Brightness - (Win 10)	Brightness -	F2
	Brightness +	Brightness +	Brightness + (Win 10)	Brightness +	F3
	Search	Search in browser or N/A	Search	Search	F4
	Previous track	Previous track	Previous track	Previous track	F5
	Play/pause	Play/pause	Play/pause	Play/pause	F6
	Next track	Next track	Next track	Next track	F7
	Volume -	Volume -	Volume -	Volume -	F8
	Volume +	Volume +	Volume +	Volume +	F9
	Battery status checking	Battery status checking	Battery status checking	Battery status checking	F10
	Screenshot	Screenshot	Screenshot	Screenshot	F11
	Screen lock	Screen lock	N/A	Screen lock	F12
	Delete	Delete	Delete	Delete	N/A

-6-

Power Saving Mode

The keyboard will enter sleep mode after being idle for 30 minutes. To activate it, press any key and wait for 3 seconds.

Charge the Keyboard

It is recommended to use our included charging cable to directly connect with the computer interface. If you prefer to connect charging cable with adapter, before to use, please check your adapter voltage is not is not higher than 5V.

--- Keyboard output: DC 5V/200mA;

USB charger is not included.

--- In charging process, the power indicator light will glow red. Generally, it takes about 2 hours to get it fully charged.

System Requirements

--- iOS 6.0 and above

--- Mac OS X 10.6 to Mac OS X 10.12 and above

--- Windows 7/ 8/10, PC computer with a Bluetooth host

--- Android 6.0 and above with Bluetooth HID profile

NOTE: it is not fully compatible with Samsung Smart TV, Bluetooth Adapter, Mac mini and Nokia phones.

FAQ

Q: My keyboard fail to connect.

Troubleshooting checklist

1. Ensure the device you are trying to pair with is Bluetooth wireless-capable.
2. Minimize the distance between the keyboard and your device as close as possible (within 30cm).
3. On your device, delete/remove previous Bluetooth connection record with "iClever IC-BK03 Keyboard".

-7-

4. On your device, turn off the Bluetooth function and turn on it again.
5. Charge keyboard for 30 minutes.
6. Try a different device.

If you still fail to connect, please contact us to ensure that you are pairing correctly.

Q: Troubleshooting for connection issues:

frequently disconnected, typing lag, key gets stuck or responds intermittently, connection drops, device cannot be connected at all.

Troubleshooting checklist

1. Restart your Bluetooth device.
2. Make sure that your iClever device and computer are within close proximity of each other.
3. Try moving away at least 8 inches (20 cm) from metal and other sources of wireless signal. Try moving away from:
 - Any device that could emit wireless waves: Microwave, cordless phone, baby monitor, wireless speaker, garage door opener, WiFi router
 - Computer power supplies
 - Metal or metal wiring in the wall
4. Do not using your wireless keyboard on metal surfaces
5. Charge your iClever keyboard for 30 minutes.
6. Check if there are any updates running in the background that may cause the delay.
7. Make sure your operating system (OS) is up to date.
8. Try on a different computer/smart phone/tablet.

Please note: if the device is lack of RAW, it may be easy to lead a typing lag. If you still suffer the connection trouble, please contact us.

Q: Under iPad and iPhone, keys of U I O J K L M are not working. Please ensure that the function of Assistive Touch and Mouse Keys is off. you could follow as below to set:
 Setting> Accessibility > Assistive Touch (turn it Off) > Mouse Keys (Turn it Off)

-8-

FCC Statement

Changes or modifications not expressly approved by the party responsible for compliance could void the user's authority to operate the equipment.

This equipment has been tested and found to comply with the limits for a Class B digital device, pursuant to Part 15 of the FCC Rules. These limits are designed to provide reasonable protection against harmful interference in a residential installation. This equipment generates, uses and can radiate radio frequency energy and, if not installed and used in accordance with the instructions, may cause harmful interference to radio communications. However, there is no guarantee that interference will not occur in a particular installation. If this equipment does cause harmful interference to radio or television reception, which can be determined by turning the equipment off and on, the user is encouraged to try to correct the interference by one or more of the following measures:

- Reorient or relocate the receiving antenna.
- Increase the separation between the equipment and receiver.
- Connect the equipment into an outlet on a circuit different from that to which the receiver is connected.
- Consult the dealer or an experienced radio/TV technician for help.

This device complies with Part 15 of the FCC Rules. Operation is subject to the following two conditions: (1) this device may not cause harmful interference, and (2) this device must accept any interference received, including interference that may cause undesired operation.

Contact

Email: support@iclever.com

-9-